

# Quick Guide - Ontrack Eraser Degausser

The following operating guideline should be followed in order to maintain a high level of security and quality. Failure to follow the operating guidelines may result in an incomplete or unsuccessful erasure.

**Note:** Before using the degausser please ensure that the degausser has been powered on at for at least 2 minutes. The operate button and the erase area will turn blue when ready.

1. Record the unit identification information (manufacturer, model and serial number)
2. Check the erasure authorization. The operator must obtain authorization from the rightful owner of the data
3. The operator must ensure that he/she has received the correct unit
4. The erasure process



The magnetic media

## 1) Units above 2,5" form factor

The magnetic media/disks needs to be near the erasure coil inside the degausser. Insert the magnetic media/unit with the magnetic disks first into the erase area. As a guideline, on a majority of disks the connectors will now be outside the erase area. If you are unsure on the position of the magnetic disks perform the erasure process with the unit oriented in both directions.

- a) Place the unit into the erase area with the electrical connectors pointing out as shown in picture 1.
- b) Push the unit gently until it meets resistance (for position see picture 1)

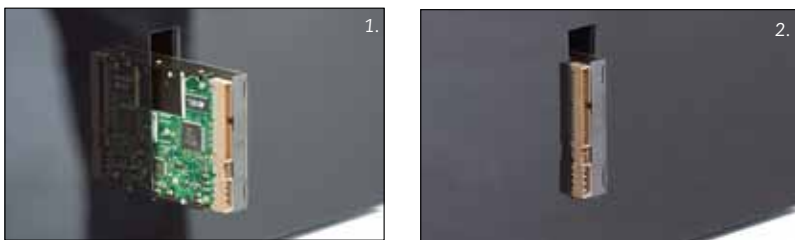

- c) Press the operate button to execute the first erasure cycle
- d) Push the unit further into the erase area until it stops in the inner end position (see picture 2.)
- e) Press the operate button to execute the second erasure cycle
- f) Push the unit gently 0.3 cm into the erase area and the unit will be ejected automatically
- g) The erasure process is finished, remove the unit from the erase area
- h) Mark the unit to indicate that it has been erased

## 2) Units on 2,5" form factor and smaller

- a) Place the unit into the erase slot in the 2,5" adapter ( see picture 3 )



- b) Insert the 2,5" adapter with the hook on platform first into the erase area ( see picture 4 )



- c) Push the 2,5" adapter gently until it meets resistance and continue until it stops in the inner end position ( see picture 5 )



- d) Press the operate button to execute the erasure cycle
- e) Push the 2,5" adapter gently 0.3 cm into the erase area and the adapter will be ejected automatically
- f) Pull the adapter out of the erase area
- g) The erasure process is finished, remove the unit from the 2,5" adapter
- h) Mark the unit to indicate that it has been erased

If the degausser fails to operate, the Operate display will show the Error. The error type can be found by using the Mode display function.

If the degausser fails to operate because the temperature gets too high, the Operate display will show Temp. The degausser will turn into a normal operate mode once the temperature returns to a normal.